

CAIRO 70



BRONPI
La excelencia en el fuego

ELIJA EL INTERIOR
 CHOOSE THE INTERIOR
 ESCOLHA O INTERIOR
 CHOISISSEZ L'INTERIEUR
 SCEGLI L'INTERNO

FACILIDAD DE ACCESO A LA TURBINA DESDE LA CÁMARA DE COMBUSTIÓN.
 EASE OF ACCESS TO THE TURBINE FROM THE COMBUSTION CHAMBER.
 FACILIDADE DE ACESSO A TURBINA A PARTIR DA CÁMARA DE COMBUSTÃO.
 FACILITÉ D'ACCÈS À LA TURBINE DEPUIS LA CHAMBRE DE COMBUSTION.
 FACILITÀ DI ACCESSO ALLA TURBINA DALLA CAMERA DI COMBUSTIONE.



12-4

81

3,3

300

Kit Vermiculite: 102 Kit Ceramic: 1040

2x120

580x306x287

60

15

Features

- Triple Combustion System
- Clean Glass System
- Max. power: 15kw
- Heating power: 12-4kw
- Efficiency (%): 81%
- Consumption (kg/h): 3,3kg/h
- Heating capacity (m3): 300m3
- Manufactured in cast-iron and steel
- Weight (kg): Kit Vermiculite: 102kg Kit Ceramic: 104kg
- Smoke exit tube diameter (mm): 150mm
- Air channel (diameter and exit tube number): 2x120
- Useful chamber measures: 580x306x287mm
- Maximum logs size (cm): 60cm

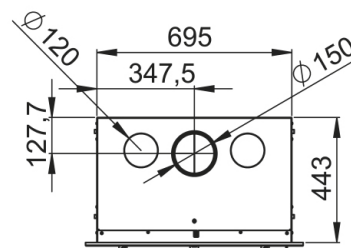
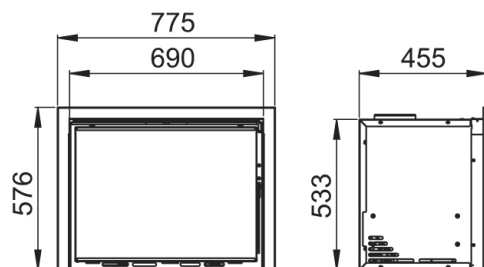

Given the continued improvement of our products and improving our manufacturing process, size, aesthetics and product specifications are subject to change without prior notice from our company.

www.bronpi.com

