

# HYDROCONFORT 27

**DOBLE SISTEMA DE LIMPIEZA** Giro 360° de la base del quemador y cepillado.  
**DOUBLE CLEANING SYSTEM** A 360-degree spin of the base of the burner.  
**DUPLO SISTEMA DE LIMPEZA** Rotação e varrido da base do queimador de 360°.  
**DOPPIO SISTEMA DI PULIZIA** Rotazione 360° della base del bruciatore e spazzolatura.  
**DOUBLE SYSTÈME DE NETTOYAGE** Rotation 360° de la base du brûleur et brossage.



|       |         |         |      |    |   |          |     |     |    |  |
|-------|---------|---------|------|----|---|----------|-----|-----|----|--|
|       |         |         |      |    |   |          |     |     |    |  |
|       |         |         |      |    |   |          |     |     |    |  |
| 84-91 | 6,4-1,6 | 150-450 | 650  | 60 |   | 9,3-37,5 | 280 | 100 | 60 |  |
|       |         |         |      |    |   |          |     |     |    |  |
| 1,5   | 3       | 260*    | 186* |    | 6 | 40/80    |     |     |    |  |
|       |         |         |      |    |   |          |     |     |    |  |

VAL-02/VAL-04/KIT WIFI

## Features

- FastOn
- Oasys Plus
- Double Cleaning System
- New Layout of the Burner
- Modulation System
- Model designed for easy access to maintenance service
- Load Level Sensor
- Model Compatible with Kit Wifi
- Programmable
- Power max: 27kw
- Power transferred to the water: 26-7kw
- Efficiency: 84-91 %
- Consumption max-min: 6,4-1,6 kg/h
- Power consumption: 150-450W
- Heating capacity: 650 m3
- Tank capacity: 60
- Metallic interior
- Autonomy (min-max): 9,9-37,5h
- Weight: 280kg
- Fume outlet diameter: 100mm

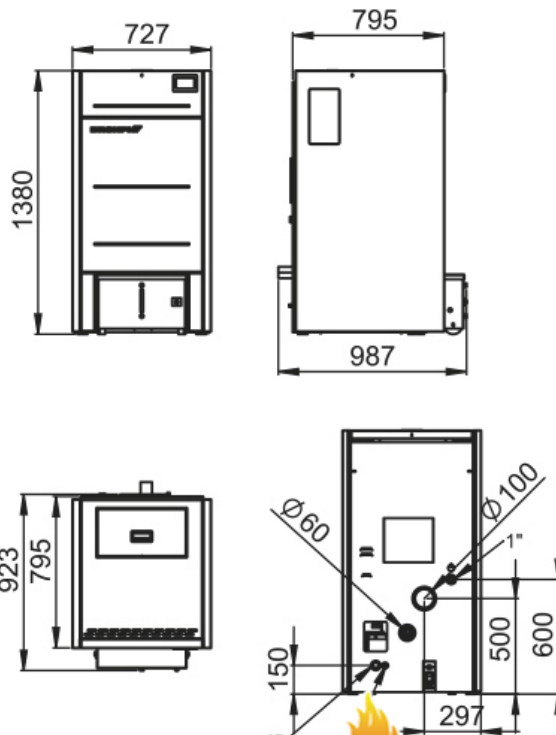

Given the continued improvement of our products and improving our manufacturing process, size, aesthetics and product specifications are subject to change without prior notice from our company.

[www.bronpi.com](http://www.bronpi.com)



## Features

- Air inlet diameter: 60mm
- Working pressure: 1,5bar
- Working maximum pressure: 3bar
- Underfloor heating: 260\*(m2)
- N° radiator elements: 186\*
- Closed expansion vessel: 6l
- Maximum service temperature: 40/80°C
- Valve for drinking water
- Circulating pump
- Hermetic tank
- Management Heating / Sanitary Water
- Security system: S2. Safety thermostat pellet, Safety thermostat water, Air flow switch, Safety valve 3 bar, Pressure setting valve
- Compatible accessories not included: VAL-02/VAL-04/KIT WIFI
- DOUBLE CLEANING SYSTEM A 360-degree spin of the base of the burner
- New patented heat exchange system.
- Cast-iron burner
- Thermally insulated chamber.
- Combustion chamber window.
- Automatic air vent included.
- Grafic LCD color Touch of 3.5" for programming and controlling the boiler.
- Height adjustable levelling feet.
- \* The calculation of radiators and underfloor heating has been determined according to normal conditions of a house insulation, located in a temperate zone. Aluminium radiator elements have been considered with a height of 60cm and a temperature difference of 50°, 120 kcal/element. Check characteristics (power) of the radiator.

Given the continued improvement of our products and improving our manufacturing process, size, aesthetics and product specifications are subject to change without prior notice from our company.

[www.bronpi.com](http://www.bronpi.com)

